

EXAMPLE PROJECT – RAIN GARDEN/BIOSWALE

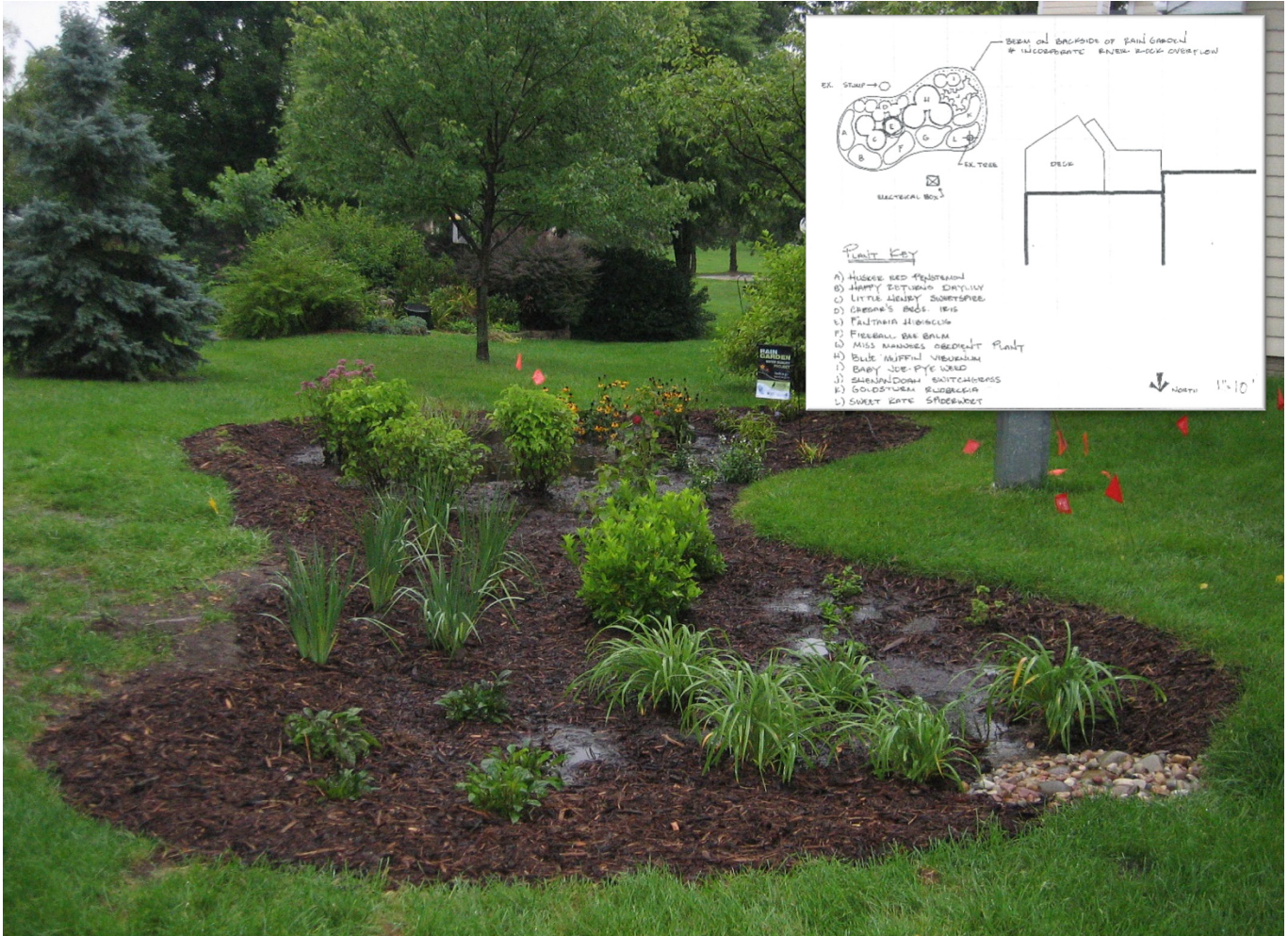

Size: 300 ft²

Total Cost: \$2,475 (Before Reimbursement)

Year Installed: 2009

Eligible Expenses

- Approved native or hardy introduced plants appropriate for rain gardens or bioswales:
 - Arrowwood Viburnum
 - Virginia Sweetspire
 - Switchgrass
 - Siberian Iris
 - Joe Pye-Weed
 - Beebalm
 - Virginia Spiderwort
 - Sedum
 - Orange Coneflower
 - Obedient Plant
 - Daylily
- Soil amendments (e.g. compost)
- Rocks for rain garden inlet and overflow
- Hardwood mulch
- Professional landscape design and installation fees

Ineligible Expenses

- Water or other utility bills
- Irrigation equipment including hoses and sprinklers

Note: The expenses listed above are not a complete list of eligible vs. ineligible expenses. They are examples of actual expenses incurred by the property owner.