

I-2 87TH & HIGHWAY 2 INTERSECTION

OLSSON ASSOCIATES

CONSULTING ENGINEERS

1111 Lincoln Mall, P.O. Box 84608, Lincoln, NE 68501

NO SCALE

PRODUCTION: 1-26-01 11:00 AM 11/11/01 0 7-01 12/21/01 10:00 AM 10/21/01

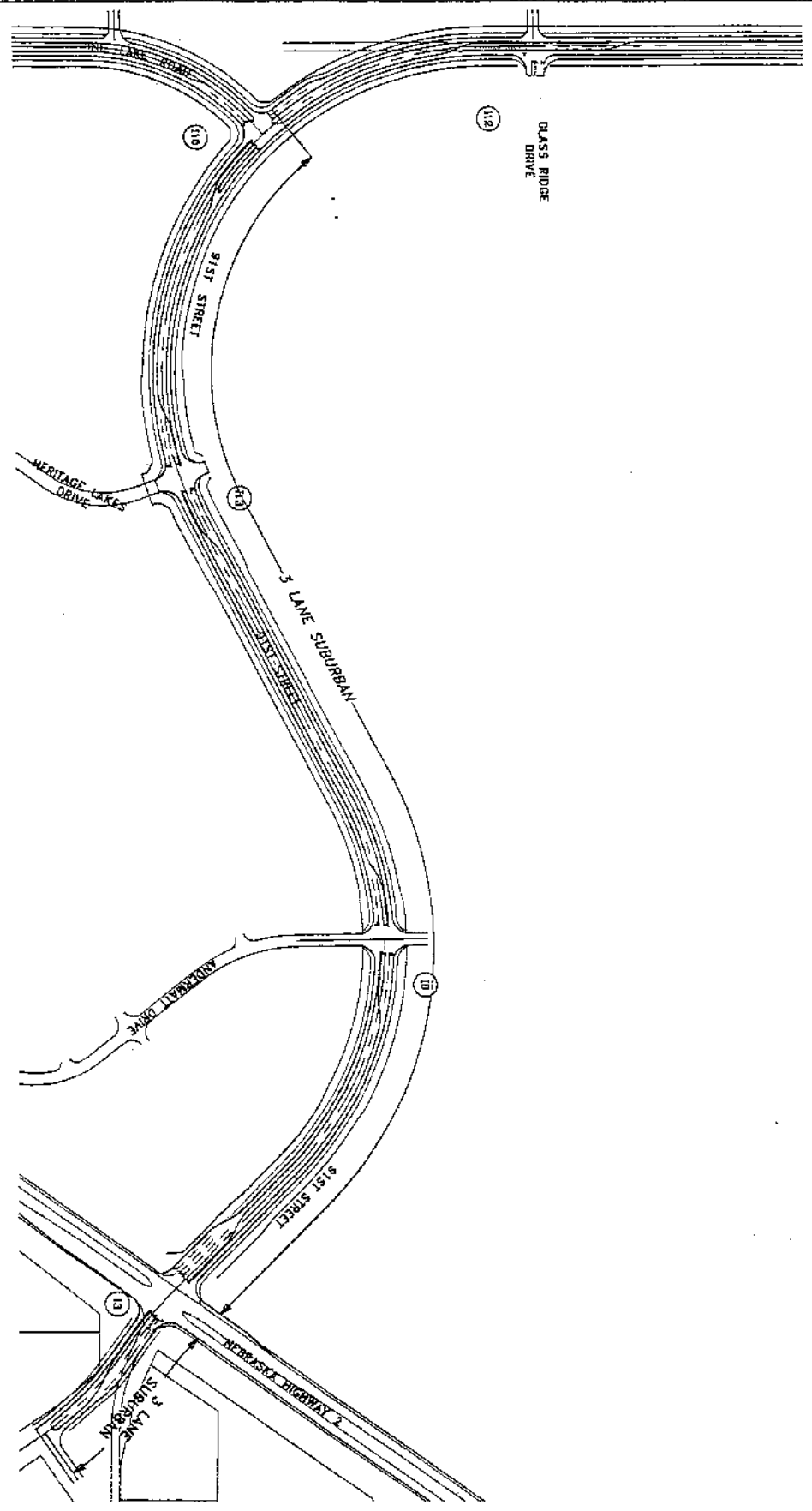

91ST STREET
 (FROM PINE LAKE ROAD TO SOUTH OF HWY 2)

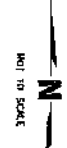

Project No. 990677
 Date: 07/01/01
 Drawn by: [Name]
 Checked by: [Name]
 Scale: 1" = 40'

UNICORP
 NEBRASKA
 2001

PROPOSED
 ROADWAY &
 INTERSECTION
 IMPROVEMENTS

KORVATH
 BATH &
 HWY 2

Attachment "I"
 Page 1 of 2

FUTURE OUTLOT TO BE PLATTED
AS PUBLIC ACCESS EASEMENT

EXISTING PINE LAKE ROAD 50'

FUTURE
PINE LAKE ROAD

FUTURE 91ST STREET

TEMPORARY ASPHALT

PAINTED ISLAND

1" = 100'

N

TEMPORARY CONNECTION FROM PROPOSED SOUTH 91ST STREET TO EXISTING PINE LAKE ROAD

OLSSON ASSOCIATES

CONSULTING ENGINEERS

1111 Lincoln Mall P.O. Box 84608 Lincoln, NE 68501

DATE:

8/15/01

Attachment "I"

Page 2 of 2

F:\PROJECTS\990677\DWG\ROAD\IMPROVE.DWG 8-15-01 9:25:58am I. Lundpl

F:\PROJECTS\990627\DWG\EXHIBITS\NINT\X11B4.DWG B-7-01 12:26:10pm Lenrdpl

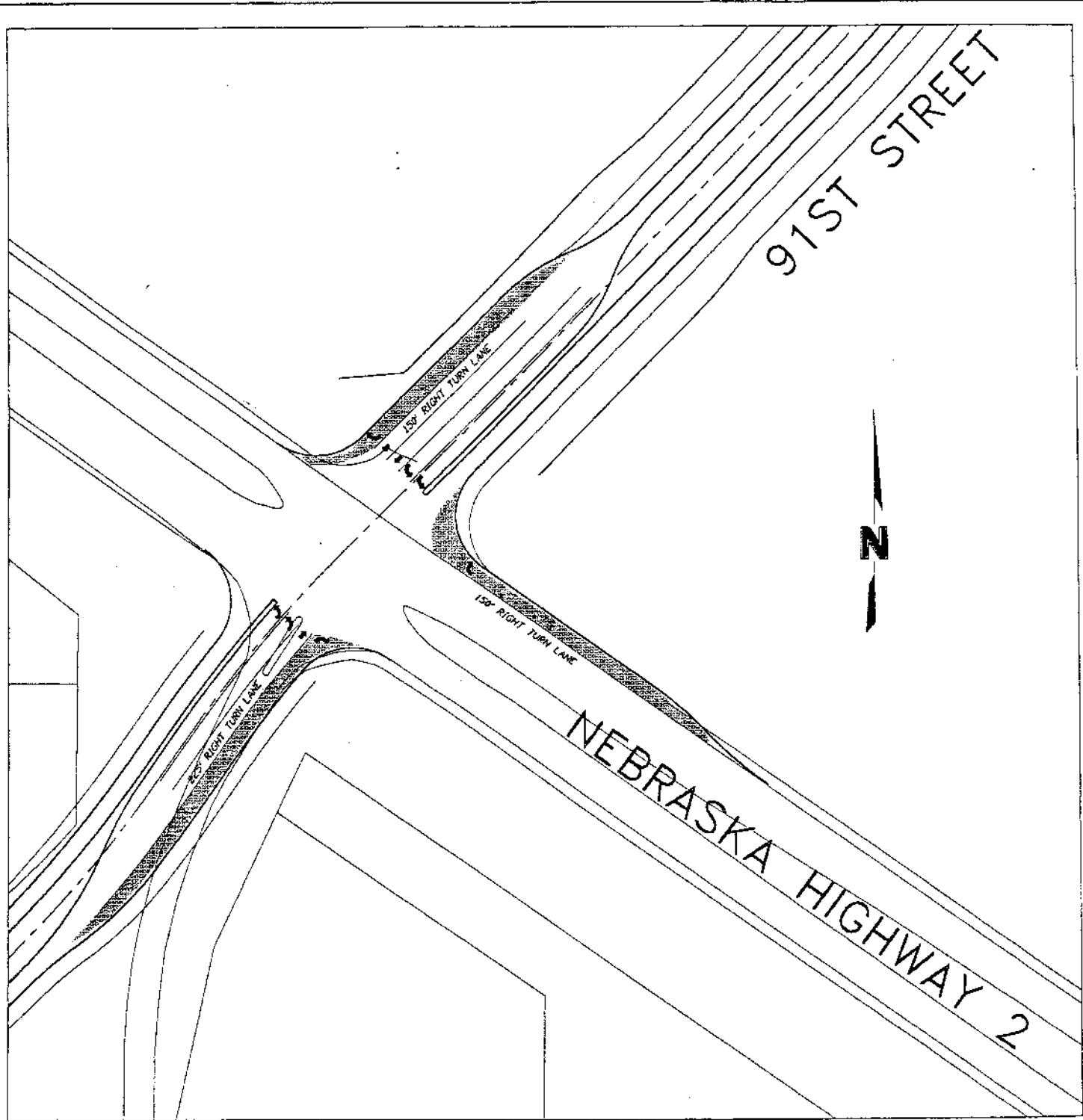

I-3 91ST & HIGHWAY 2 INTERSECTION

OLSSON ASSOCIATES
 CONSULTING ENGINEERS
 1111 Lincoln Mall, P.O. Box R4608, Lincoln, NE 68501

NO SCALE

PINE LAKE ROAD
 (FROM 84TH STREET TO 91ST STREET)

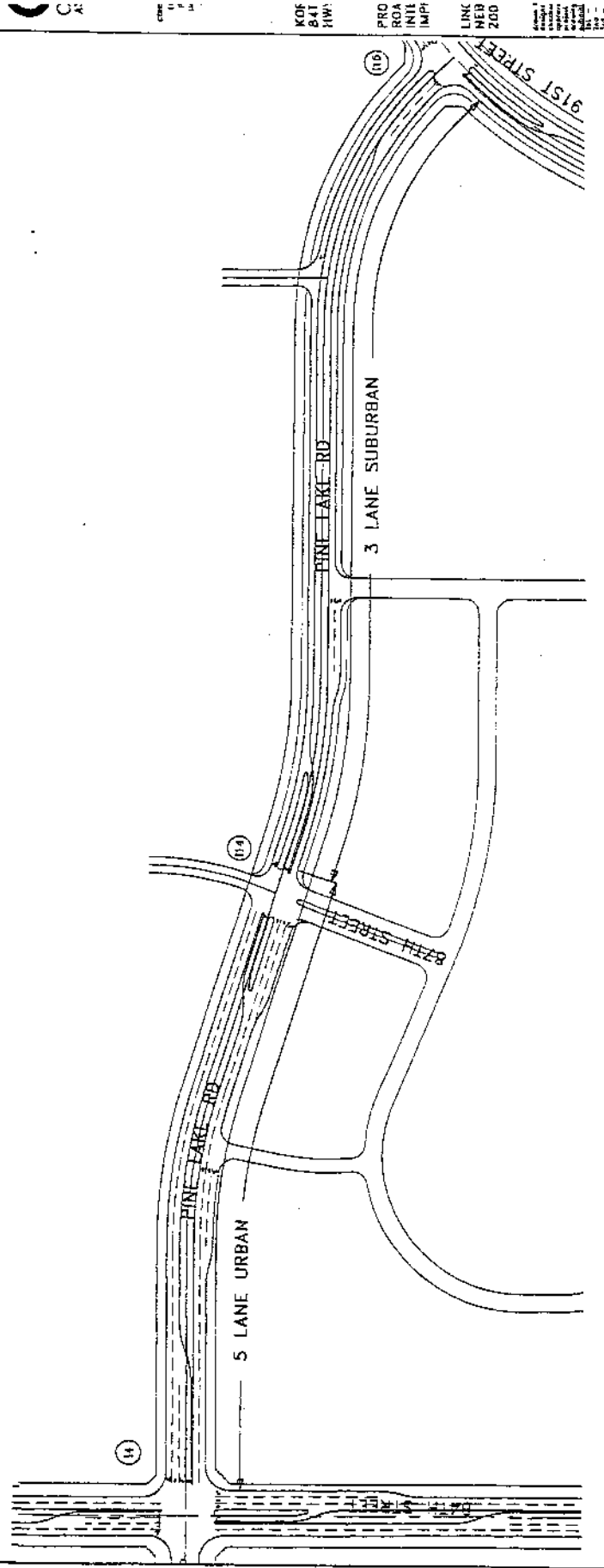
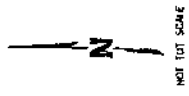

KOS
 BJT
 RWY
 PRO
 BOA
 INTL
 IMPA
 LINK
 HEB
 200
 1
 2
 3
 4
 5
 6
 7
 8
 9
 10
 11
 12
 13
 14
 15
 16
 17
 18
 19
 20
 21
 22
 23
 24
 25
 26
 27
 28
 29
 30
 31
 32
 33
 34
 35
 36
 37
 38
 39
 40
 41
 42
 43
 44
 45
 46
 47
 48
 49
 50
 51
 52
 53
 54
 55
 56
 57
 58
 59
 60
 61
 62
 63
 64
 65
 66
 67
 68
 69
 70
 71
 72
 73
 74
 75
 76
 77
 78
 79
 80
 81
 82
 83
 84
 85
 86
 87
 88
 89
 90
 91
 92
 93
 94
 95
 96
 97
 98
 99
 100

F:\PROJECTS\990677\DWG\KXH31TS\ROAD\KXH31TS.DWG B-7-D1 1/3/17 10:47 AM

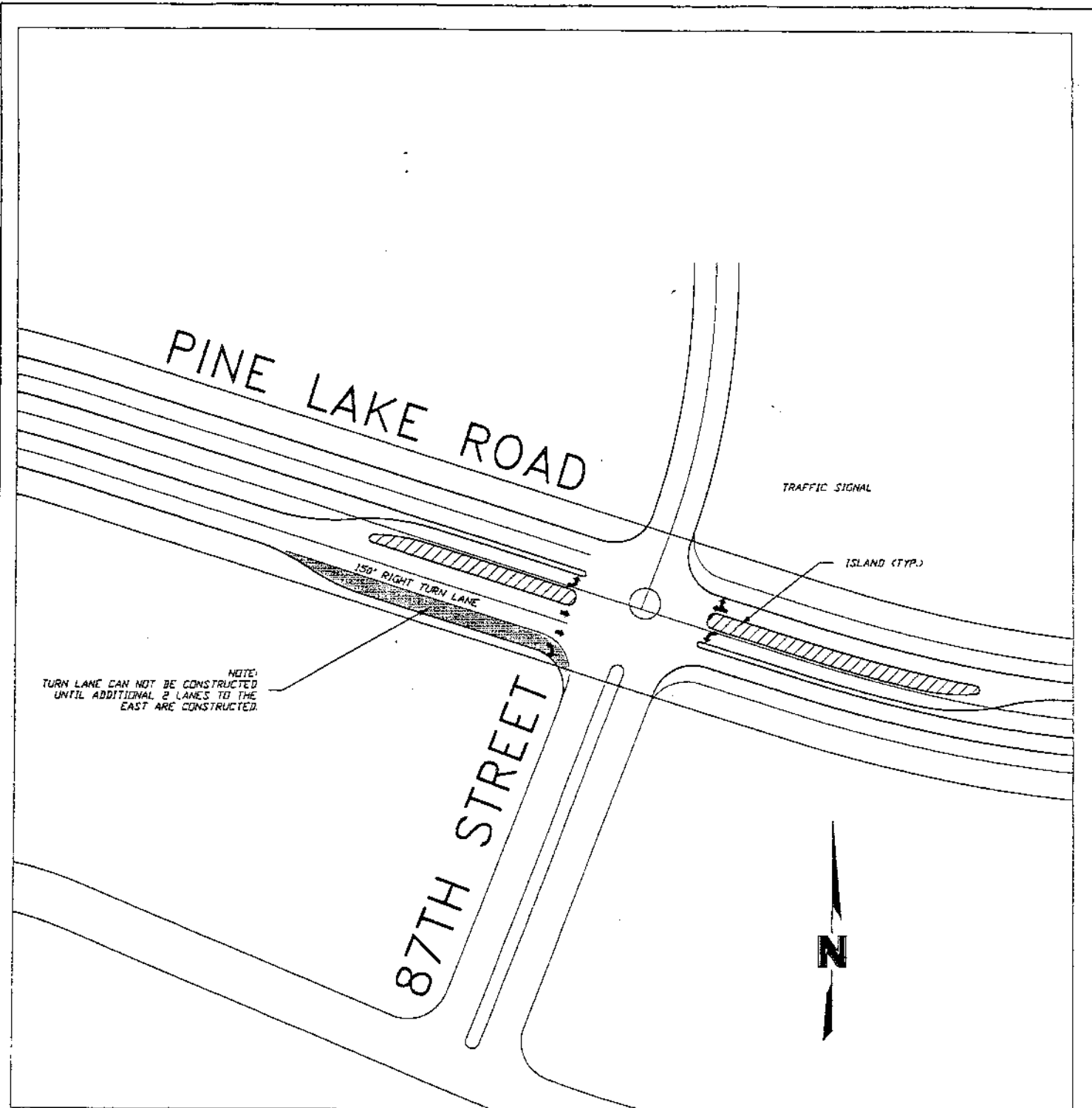

I-12 87TH & PINE LAKE ROAD INTERSECTION

OLSSON ASSOCIATES

CONSULTING ENGINEERS

1111 Lincoln Mall, P.O. Box 8460R Lincoln, NE 68501

NO SCALE

F:\PROJECTS\990627\DWG\EXHIBITS\INTE\X11186.DWG 0 7-01 12:30:37pm Lardopf

PINE LAKE ROAD

91ST STREET

N

ISLAND (TYP.)

I-15 91ST & PINE LAKE ROAD INTERSECTION

OLSSON ASSOCIATES

CONSULTING ENGINEERS

1111 Lincoln Mall, P.O. Box 84608 Lincoln, NE 68501

NO SCALE

C:\PSD\41312\9106\7\PS6\EXHIBITS\W\EXHIB9.DWG B-7-01 12:34:36pm 1/26/04

PINE LAKE ROAD
(FROM 91ST STREET TO 98TH STREET)

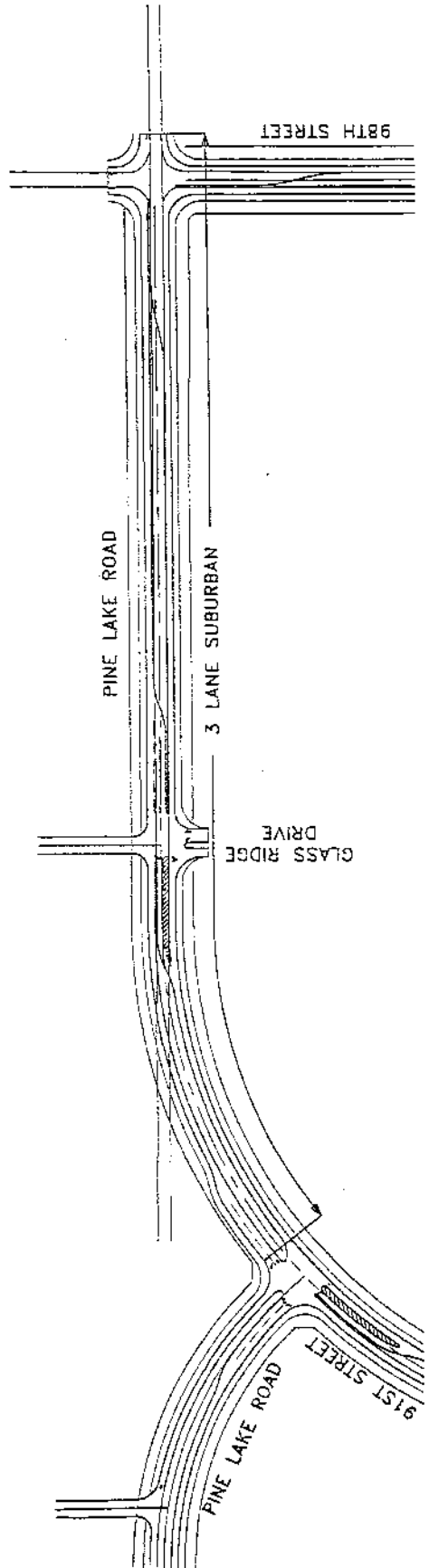
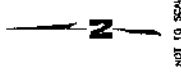

KOI 841 HW PRC ROJ INTI LMP LIN NEE ZDC
Date: 11/11/11
Scale: 1" = 40'

F:\PROJECTS\990677\DWG\ENR\11\11\ROAD\K-18.DWG 8-7-11 1:52:25pm L:\RMB

MATCH LINE TO ABOVE VIEW

PINE LAKE ROAD

98TH STREET

3 LANE SUBURBAN

(FROM MATCH LINE SOUTH TO HWY 2)

98TH STREET

SOUTH INTERSECTION

WIDGEON LANE

98TH STREET

3 LANE SUBURBAN

(FROM PINE LAKE ROAD SOUTH TO MATCH LINE)

98TH STREET



MATCH LINE TO BELOW VIEW

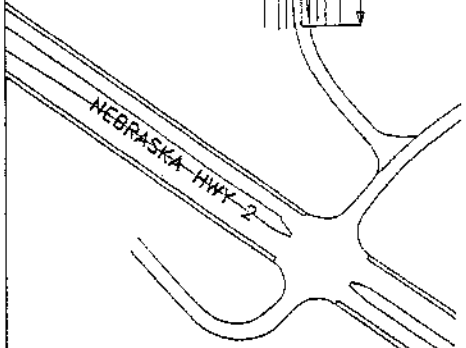

Attachment "M"

KORNER
EARTH &
HWY 2

PROPOSED
ROADWAY &
INTERSECTION
IMPROVEMENTS

LINCOLN
NEBRASKA
2001

Scale of 1" = 40'
Checked by: [Signature]
Designed by: [Signature]
Drawn by: [Signature]
Date: 8/7/01

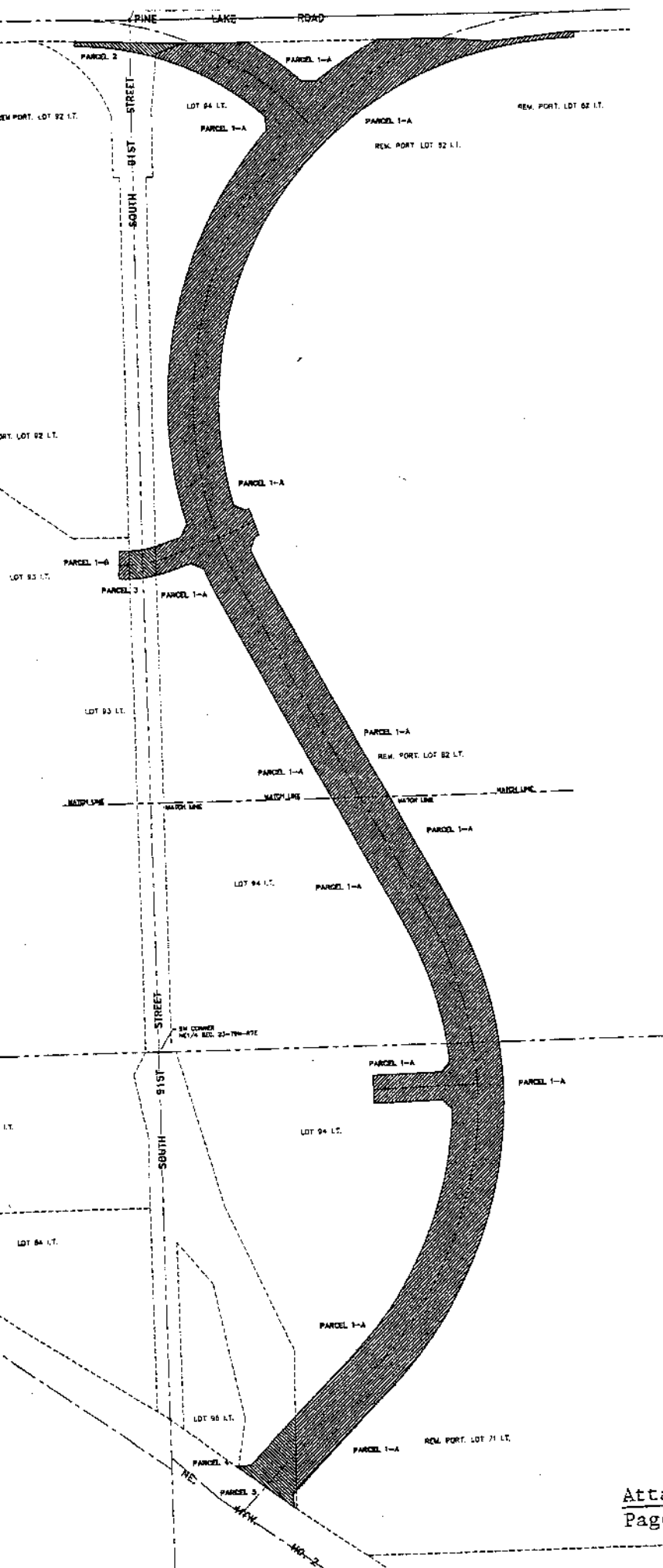

**LEGAL DESCRIPTION
SO. 91ST STREET ROW
PARCEL 1-A**

A LEGAL DESCRIPTION FOR A TRACT OF LAND COMPOSED OF A PORTION OF LOT 94 I.T., LOCATED IN THE EAST HALF OF SECTION 23, TOWNSHIP 9 NORTH, RANGE 7 EAST OF THE 6TH P.M., LANCASTER COUNTY, NEBRASKA, AND MORE PARTICULARLY DESCRIBED AS FOLLOWS:

COMMENCING AT THE NORTHWEST CORNER OF THE NORTHEAST QUARTER OF SAID SECTION 23, THENCE ON AN ASSUMED BEARING OF SOUTH 00 DEGREES 12 MINUTES 46 SECONDS WEST ALONG THE WEST LINE OF SAID NORTHEAST QUARTER, A DISTANCE OF 55.27 FEET TO A POINT OF INTERSECTION WITH THE SOUTH RIGHT-OF-WAY LINE OF PINE LAKE ROAD, THENCE SOUTH 88 DEGREES 13 MINUTES 12 SECONDS EAST ALONG THE SOUTH LINE OF SAID RIGHT-OF-WAY, A DISTANCE OF 134.78 FEET TO A NORTHWEST CORNER OF SAID LOT 94 I.T., SAID POINT BEING **THE TRUE POINT OF BEGINNING**, THENCE NORTH 89 DEGREES 52 MINUTES 54 SECONDS EAST ALONG THE NORTH LINE OF SAID LOT 94 I.T., A DISTANCE OF 166.98 FEET TO A POINT, THENCE ALONG A CURVE IN A CLOCKWISE DIRECTION, HAVING A RADIUS OF 865.00 FEET, ARC LENGTH OF 169.82 FEET, DELTA ANGLE OF 11 DEGREES 14 MINUTES 54 SECONDS, A CHORD BEARING OF SOUTH 53 DEGREES 06 MINUTES 42 SECONDS EAST, AND A CHORD LENGTH OF 169.55 FEET TO A POINT, THENCE SOUTH 87 DEGREES 50 MINUTES 45 SECONDS EAST, A DISTANCE OF 37.63 FEET TO A POINT, THENCE ALONG A CURVE IN A CLOCKWISE DIRECTION, HAVING A RADIUS OF 1065.00 FEET, ARC LENGTH OF 189.65 FEET, DELTA ANGLE OF 10 DEGREES 12 MINUTES 11 SECONDS, A CHORD BEARING OF NORTH 56 DEGREES 44 MINUTES 29 SECONDS EAST, AND A CHORD LENGTH OF 189.40 FEET TO A POINT OF INTERSECTION WITH THE NORTH LINE OF SAID LOT 94 I.T., THENCE NORTH 89 DEGREES 52 MINUTES 54 SECONDS EAST ALONG THE NORTH LINE OF SAID LOT 94 I.T., A DISTANCE OF 179.66 FEET TO A POINT OF DEFLECTION, THENCE SOUTH 84 DEGREES 24 MINUTES 28 SECONDS EAST ALONG A NORTH LINE OF SAID LOT 94 I.T., A DISTANCE OF 100.50 FEET TO A POINT OF DEFLECTION, THENCE NORTH 84 DEGREES 10 MINUTES 16 SECONDS EAST ALONG A NORTH LINE OF SAID LOT 94 I.T., A DISTANCE OF 201.00 FEET TO A POINT OF DEFLECTION, THENCE NORTH 89 DEGREES 52 MINUTES 54 SECONDS EAST ALONG A NORTH LINE OF SAID LOT 94 I.T., A DISTANCE OF 20.96 FEET TO THE NORTHEAST CORNER OF SAID LOT 94 I.T., THENCE SOUTH 00 DEGREES 07 MINUTES 06 SECONDS EAST ALONG THE EAST LINE OF SAID LOT 94 I.T., A DISTANCE OF 15.00 FEET TO A SOUTHEAST CORNER OF SAID LOT 94 I.T., THENCE ALONG A CURVE IN A COUNTER CLOCKWISE DIRECTION, HAVING A RADIUS OF 935.00 FEET, ARC LENGTH OF 1708.62 FEET, DELTA ANGLE OF 104 DEGREES 42 MINUTES 09 SECONDS, A CHORD BEARING OF SOUTH 37 DEGREES 31

MINUTES 50 SECONDS WEST ALONG A EAST LINE OF SAID LOT 94 I.T., AND A CHORD LENGTH OF 1480.61 FEET TO A POINT, THENCE SOUTH 64 DEGREES 45 MINUTES 06 SECONDS EAST ALONG A EAST LINE OF SAID LOT 94 I.T., A DISTANCE OF 32.69 FEET TO A POINT, THENCE NORTH 66 DEGREES 05 MINUTES 00 SECONDS EAST ALONG A EAST LINE OF SAID LOT 94 I.T., A DISTANCE OF 10.04 FEET TO A POINT, THENCE SOUTH 18 DEGREES 34 MINUTES 09 SECONDS EAST ALONG A EAST LINE OF SAID LOT 94 I.T., A DISTANCE OF 72.31 FEET TO A POINT, THENCE SOUTH 66 DEGREES 05 MINUTES 00 SECONDS WEST ALONG A EAST LINE OF SAID LOT 94 I.T., A DISTANCE OF 10.04 FEET TO A POINT, THENCE SOUTH 22 DEGREES 15 MINUTES 58 SECONDS WEST ALONG A EAST LINE OF SAID LOT 94 I.T., A DISTANCE OF 36.08 FEET TO A POINT, THENCE ALONG A CURVE IN A COUNTER CLOCKWISE DIRECTION, HAVING A RADIUS OF 935.00 FEET, ARC LENGTH OF 87.23 FEET, DELTA ANGLE OF 05 DEGREES 20 MINUTES 44 SECONDS, A CHORD BEARING OF SOUTH 24 DEGREES 59 MINUTES 24 SECONDS EAST ALONG A EAST LINE OF SAID LOT 94 I.T., AND A CHORD LENGTH OF 87.20 FEET TO A POINT, THENCE SOUTH 27 DEGREES 39 MINUTES 47 SECONDS EAST ALONG A EAST LINE OF SAID LOT 94 I.T., A DISTANCE OF 937.76 FEET TO A POINT, THENCE ALONG A CURVE IN A CLOCKWISE DIRECTION, HAVING A RADIUS OF 1065.00 FEET, ARC LENGTH OF 1338.36 FEET, DELTA ANGLE OF 72 DEGREES 00 MINUTES 09 SECONDS, A CHORD BEARING OF SOUTH 08 DEGREES 20 MINUTES 18 SECONDS WEST ALONG A EAST LINE OF SAID LOT 94 I.T., AND A CHORD LENGTH OF 1252.02 FEET TO A POINT, THENCE SOUTH 44 DEGREES 20 MINUTES 22 SECONDS WEST ALONG A EAST LINE OF SAID LOT 94 I.T., A DISTANCE OF 370.73 FEET TO A POINT OF INTERSECTION WITH THE WEST LINE OF SAID LOT 94 I.T., SAID LINE BEING THE EAST RIGHT-OF-WAY LINE OF SOUTH 91ST STREET, THENCE NORTH 01 DEGREES 07 MINUTES 21 SECONDS EAST ALONG THE WEST LINE OF SAID LOT 94 I.T., SAID LINE BEING THE EAST LINE OF SAID RIGHT-OF-WAY, A DISTANCE OF 189.85 FEET TO A POINT, THENCE NORTH 44 DEGREES 20 MINUTES 22 SECONDS EAST, A DISTANCE OF 232.37 FEET TO A POINT, THENCE ALONG A CURVE IN A COUNTER CLOCKWISE DIRECTION, HAVING A RADIUS OF 935.00 FEET, ARC LENGTH OF 680.58 FEET, DELTA ANGLE OF 41 DEGREES 42 MINUTES 18 SECONDS, A CHORD BEARING OF NORTH 23 DEGREES 29 MINUTES 13 SECONDS EAST, AND A CHORD LENGTH OF 665.65 FEET TO A POINT, THENCE NORTH 44 DEGREES 37 MINUTES 04 SECONDS WEST, A DISTANCE OF 34.43 FEET TO A POINT, THENCE SOUTH 88 DEGREES 53 MINUTES 45 SECONDS WEST, A DISTANCE OF 174.03 FEET TO A POINT, THENCE NORTH 01 DEGREES 06 MINUTES 15 SECONDS WEST, A DISTANCE OF 72.00 FEET TO A POINT, THENCE NORTH 88 DEGREES 53 MINUTES 45 SECONDS EAST, A DISTANCE OF 174.03 FEET TO A POINT, THENCE NORTH 42 DEGREES 24 MINUTES 34 SECONDS EAST, A DISTANCE OF 34.43 FEET TO A POINT, THENCE ALONG A CURVE IN A COUNTER CLOCKWISE DIRECTION, HAVING A RADIUS OF 935.00 FEET, ARC LENGTH OF 372.40 FEET, DELTA ANGLE OF 22 DEGREES

49 MINUTES 13 SECONDS, A CHORD BEARING OF NORTH 16 DEGREES 15 MINUTES 10 SECONDS WEST, AND A CHORD LENGTH OF 369.94 FEET TO A POINT, THENCE NORTH 27 DEGREES 39 MINUTES 47 SECONDS WEST, A DISTANCE OF 937.76 FEET TO A POINT, THENCE ALONG A CURVE IN A CLOCKWISE DIRECTION, HAVING A RADIUS OF 1065.00 FEET, ARC LENGTH OF 101.48 FEET, DELTA ANGLE OF 05 DEGREES 27 MINUTES 34 SECONDS, A CHORD BEARING OF NORTH 24 DEGREES 56 MINUTES 00 SECONDS WEST, AND A CHORD LENGTH OF 101.44 FEET TO A POINT, THENCE NORTH 65 DEGREES 13 MINUTES 34 SECONDS WEST, A DISTANCE OF 36.15 FEET TO A POINT, THENCE SOUTH 71 DEGREES 04 MINUTES 43 SECONDS WEST, A DISTANCE OF 57.97 FEET TO A POINT, THENCE ALONG A CURVE IN A CLOCKWISE DIRECTION, HAVING A RADIUS OF 336.00 FEET, ARC LENGTH OF 35.57 FEET, DELTA ANGLE OF 06 DEGREES 03 MINUTES 57 SECONDS, A CHORD BEARING OF SOUTH 74 DEGREES 06 MINUTES 41 SECONDS WEST, AND A CHORD LENGTH OF 35.55 FEET TO A POINT OF INTERSECTION WITH THE WEST LINE OF SAID LOT 94 I.T., SAID LINE BEING THE EAST LINE OF SOUTH 91ST STREET RIGHT-OF-WAY, THENCE NORTH 00 DEGREES 12 MINUTES 46 SECONDS EAST ALONG THE WEST LINE OF SAID LOT 94 I.T., SAID LINE BEING THE EAST LINE OF SAID RIGHT-OF-WAY, A DISTANCE OF 74.47 FEET TO A POINT, THENCE ALONG A CURVE IN A COUNTER CLOCKWISE DIRECTION, HAVING A RADIUS OF 264.00 FEET, ARC LENGTH OF 11.10 FEET, DELTA ANGLE OF 02 DEGREES 24 MINUTES 32 SECONDS, A CHORD BEARING OF NORTH 72 DEGREES 16 MINUTES 59 SECONDS EAST, AND A CHORD LENGTH OF 11.10 FEET TO A POINT, THENCE NORTH 71 DEGREES 04 MINUTES 43 SECONDS EAST, A DISTANCE OF 57.97 FEET TO A POINT, THENCE NORTH 27 DEGREES 23 MINUTES 01 SECONDS EAST, A DISTANCE OF 36.15 FEET TO A POINT, THENCE ALONG A CURVE IN A CLOCKWISE DIRECTION, HAVING A RADIUS OF 1065.00 FEET, ARC LENGTH OF 1070.33 FEET, DELTA ANGLE OF 57 DEGREES 34 MINUTES 57 SECONDS, A CHORD BEARING OF NORTH 13 DEGREES 09 MINUTES 07 SECONDS EAST, AND A CHORD LENGTH OF 1025.85 FEET TO A POINT, THENCE NORTH 02 DEGREES 19 MINUTES 38 SECONDS WEST, A DISTANCE OF 35.39 FEET TO A POINT, THENCE ALONG A CURVE IN A COUNTER CLOCKWISE DIRECTION, HAVING A RADIUS OF 735.00 FEET, ARC LENGTH OF 321.55 FEET, DELTA ANGLE OF 25 DEGREES 03 MINUTES 56 SECONDS, A CHORD BEARING OF NORTH 60 DEGREES 46 MINUTES 39 SECONDS WEST, AND A CHORD LENGTH OF 318.99 FEET TO A POINT OF INTERSECTION WITH THE WEST LINE OF SAID LOT 94 I.T., SAID LINE BEING THE EAST LINE OF SOUTH 91ST STREET RIGHT-OF-WAY, THENCE NORTH 06 DEGREES 00 MINUTES 36 SECONDS EAST ALONG A WEST LINE OF SAID LOT 94 I.T., SAID LINE BEING THE EAST LINE OF SAID RIGHT-OF-WAY, A DISTANCE OF 9.92 FEET TO A NORTHWEST CORNER OF SAID LOT 94 I.T., THENCE NORTH 70 DEGREES 11 MINUTES 42 SECONDS EAST ALONG A NORTHWEST LINE OF SAID LOT 94 I.T., SAID LINE BEING THE EAST LINE OF SAID RIGHT-OF-WAY, A DISTANCE OF 74.21 FEET TO THE POINT OF BEGINNING, SAID TRACT

CONTAINS A CALCULATED AREA OF 613,082.50 SQUARE FEET OR 14.07 ACRES, MORE OR LESS.

TOGETHER WITH:

PARCEL 1-B

A LEGAL DESCRIPTION FOR A TRACT OF LAND COMPOSED OF A PORTION OF LOT 93 I.T., LOCATED IN THE NORTHWEST QUARTER OF SECTION 23, TOWNSHIP 9 NORTH, RANGE 7 EAST OF THE 6TH P.M., LANCASTER COUNTY, NEBRASKA, AND MORE PARTICULARLY DESCRIBED AS FOLLOWS:

COMMENCING AT THE NORTHEAST CORNER OF THE NORTHWEST QUARTER OF SAID SECTION 23, THENCE ON AN ASSUMED BEARING OF SOUTH 00 DEGREES 12 MINUTES 46 SECONDS WEST ALONG THE EAST LINE OF SAID NORTHWEST QUARTER, A DISTANCE OF 1346.57 FEET TO A POINT, THENCE ALONG A CURVE IN A CLOCKWISE DIRECTION, HAVING A RADIUS OF 264.00 FEET, ARC LENGTH OF 33.19 FEET, DELTA ANGLE OF 07 DEGREES 12 MINUTES 11 SECONDS, A CHORD BEARING OF SOUTH 84 DEGREES 26 MINUTES 45 SECONDS WEST, AND A CHORD LENGTH OF 33.17 FEET TO A POINT OF INTERSECTION WITH THE WEST RIGHT-OF-WAY LINE OF SOUTH 91ST STREET, SAID LINE BEING THE EAST LINE OF SAID LOT 91 I.T., AND **THE TRUE POINT OF BEGINNING**, THENCE SOUTH 00 DEGREES 12 MINUTES 46 SECONDS WEST ALONG THE EAST LINE OF SAID LOT 93 I.T., SAID LINE BEING THE WEST LINE OF SAID RIGHT-OF-WAY, A DISTANCE OF 72.04 FEET TO A POINT, THENCE ALONG A CURVE IN A CLOCKWISE DIRECTION, HAVING A RADIUS OF 336.00 FEET, ARC LENGTH OF 27.67 FEET, DELTA ANGLE OF 04 DEGREES 43 MINUTES 08 SECONDS, A CHORD BEARING OF NORTH 89 DEGREES 07 MINUTES 44 SECONDS WEST, AND A CHORD LENGTH OF 27.67 FEET TO A POINT, THENCE NORTH 03 DEGREES 13 MINUTES 50 SECONDS EAST, A DISTANCE OF 72.00 FEET TO A POINT, THENCE ALONG A CURVE IN A COUNTER CLOCKWISE DIRECTION, HAVING A RADIUS OF 264.00 FEET, ARC LENGTH OF 23.88 FEET, DELTA ANGLE OF 05 DEGREES 10 MINUTES 59 SECONDS, A CHORD BEARING OF SOUTH 89 DEGREES 21 MINUTES 39 SECONDS EAST, AND A CHORD LENGTH OF 23.87 FEET TO THE POINT OF BEGINNING, SAID TRACT CONTAINS A CALCULATED AREA OF 1,855.96 SQUARE FEET OR 0.04 ACRES, MORE OR LESS.

October 25, 2001 (12:50PM)
F:\Projects\990677\yplat\dwg\p1.rtf

**LEGAL DESCRIPTION
SO. 91ST STREET ROW
PARCEL 2**

A LEGAL DESCRIPTION FOR A TRACT OF LAND COMPOSED OF A PORTION OF SOUTH 91ST STREET RIGHT-OF-WAY, LOCATED IN THE NORTH HALF OF SECTION 23, TOWNSHIP 9 NORTH, RANGE 7 EAST OF THE 6TH P.M., LANCASTER COUNTY, NEBRASKA, AND MORE PARTICULARLY DESCRIBED AS FOLLOWS:

COMMENCING AT THE NORTHWEST CORNER OF THE NORTHEAST QUARTER OF SAID SECTION 23, THENCE ON AN ASSUMED BEARING OF SOUTH 00 DEGREES 12 MINUTES 46 SECONDS WEST ALONG THE WEST LINE OF SAID NORTHEAST QUARTER, A DISTANCE OF 55.54 FEET TO A POINT OF INTERSECTION WITH THE SOUTH RIGHT-OF-WAY LINE OF PINE LAKE ROAD, SAID POINT BEING THE **TRUE POINT OF BEGINNING**, THENCE SOUTH 88 DEGREES 13 MINUTES 12 SECONDS EAST ALONG THE SOUTH LINE OF SAID RIGHT-OF-WAY, A DISTANCE OF 134.78 FEET TO A NORTHWEST CORNER OF LOT 94 I.T., THENCE SOUTH 70 DEGREES 11 MINUTES 42 SECONDS WEST ALONG A NORTHWEST LINE OF SAID LOT 94 I.T., SAID LINE BEING THE EAST RIGHT-OF-WAY LINE OF SOUTH 91ST STREET, A DISTANCE OF 74.21 FEET TO A NORTHWEST CORNER OF SAID LOT 94 I.T., THENCE SOUTH 06 DEGREES 00 MINUTES 36 SECONDS WEST ALONG A WEST LINE OF SAID LOT 94 I.T., SAID LINE BEING THE EAST LINE OF SAID RIGHT-OF-WAY, A DISTANCE OF 9.92 FEET TO THE POINT, THENCE ALONG A CURVE IN A COUNTER CLOCKWISE DIRECTION, HAVING A RADIUS OF 735.00 FEET, ARC LENGTH OF 207.80 FEET, DELTA ANGLE OF 16 DEGREES 11 MINUTES 55 SECONDS, A CHORD BEARING OF NORTH 81 DEGREES 24 MINUTES 35 SECONDS WEST, AND A CHORD LENGTH OF 207.11 FEET TO A POINT, THENCE NORTH 00 DEGREES 29 MINUTES 28 SECONDS EAST, A DISTANCE OF 12.63 FEET TO A POINT OF INTERSECTION WITH THE SOUTH RIGHT-OF-WAY LINE OF PINE LAKE ROAD, THENCE SOUTH 88 DEGREES 13 MINUTES 12 SECONDS EAST ALONG THE SOUTH LINE OF SAID RIGHT-OF-WAY, A DISTANCE OF 140.89 FEET TO THE POINT OF BEGINNING, SAID TRACT CONTAINS A CALCULATED AREA OF 5,076.72 SQUARE FEET OR 0.12 ACRES, MORE OR LESS.

October 25, 2001 (10:24AM)
F:\Projects\990677\yplat\dwg\p2.rtf

**LEGAL DESCRIPTION
SO. 91ST STREET ROW
PARCEL 3**

A LEGAL DESCRIPTION FOR A TRACT OF LAND COMPOSED OF A PORTION OF SOUTH 91ST STREET RIGHT-OF-WAY, LOCATED IN THE NORTH HALF OF SECTION 23, TOWNSHIP 9 NORTH, RANGE 7 EAST OF THE 6TH P.M., LANCASTER COUNTY, NEBRASKA, AND MORE PARTICULARLY DESCRIBED AS FOLLOWS:

COMMENCING AT THE NORTHWEST CORNER OF THE NORTHEAST QUARTER OF SAID SECTION 23, THENCE ON AN ASSUMED BEARING OF SOUTH 00 DEGREES 12 MINUTES 46 SECONDS WEST ALONG THE WEST LINE OF SAID NORTHEAST QUARTER, A DISTANCE OF 1346.57 FEET TO A POINT, SAID POINT BEING **THE TRUE POINT OF BEGINNING**, THENCE ALONG A CURVE IN A COUNTER CLOCKWISE DIRECTION, HAVING A RADIUS OF 264.00 FEET, ARC LENGTH OF 33.90 FEET, DELTA ANGLE OF 07 DEGREES 21 MINUTES 24 SECONDS, A CHORD BEARING OF NORTH 77 DEGREES 09 MINUTES 58 SECONDS EAST, AND A CHORD LENGTH OF 33.87 FEET TO A POINT OF INTERSECTION WITH THE EAST RIGHT-OF-WAY LINE OF SAID SOUTH 91ST STREET, SAID LINE BEING THE WEST LINE OF SAID LOT 94 I.T., THENCE SOUTH 00 DEGREES 12 MINUTES 46 SECONDS WEST ALONG THE EAST LINE OF SAID RIGHT-OF-WAY, SAID LINE BEING THE WEST LINE OF SAID LOT 94 I.T., A DISTANCE OF 74.47 FEET TO A POINT, THENCE ALONG A CURVE IN A CLOCKWISE DIRECTION, HAVING A RADIUS OF 336.00 FEET, ARC LENGTH OF 66.66 FEET, DELTA ANGLE OF 11 DEGREES 22 MINUTES 02 SECONDS, A CHORD BEARING OF SOUTH 82 DEGREES 49 MINUTES 41 SECONDS WEST, AND A CHORD LENGTH OF 66.55 FEET TO A POINT OF INTERSECTION WITH THE WEST LINE OF SAID SOUTH 19ST STREET RIGHT-OF-WAY, SAID LINE BEING THE EAST LINE OF LOT 93 I.T., THENCE NORTH 00 DEGREES 12 MINUTES 46 SECONDS EAST ALONG THE WEST LINE OF SAID RIGHT-OF-WAY, SAID LINE BEING THE EAST LINE OF SAID LOT 93 I.T., A DISTANCE OF 72.04 FEET TO A POINT, THENCE ALONG A CURVE IN A COUNTER CLOCKWISE DIRECTION, HAVING A RADIUS OF 264.00 FEET, ARC LENGTH OF 33.19 FEET, DELTA ANGLE OF 07 DEGREES 12 MINUTES 11 SECONDS, A CHORD BEARING OF NORTH 84 DEGREES 26 MINUTES 45 SECONDS EAST, AND A CHORD LENGTH OF 33.17 FEET TO THE POINT OF BEGINNING, SAID TRACT CONTAINS A CALCULATED AREA OF 4,813.12 SQUARE FEET OR 0.11 ACRES, MORE OR LESS.

October 25, 2001 (12:56PM)
F:\Projects\990677\yplat\dwg\IP3.rtf

**LEGAL DESCRIPTION
SO. 91ST STREET ROW
PARCEL 4**

A LEGAL DESCRIPTION FOR A TRACT OF LAND COMPOSED OF A PORTION OF SOUTH 91ST STREET RIGHT-OF-WAY, LOCATED IN THE SOUTHEAST QUARTER OF SECTION 23, TOWNSHIP 9 NORTH, RANGE 7 EAST OF THE 6TH P.M., LANCASTER COUNTY, NEBRASKA, AND MORE PARTICULARLY DESCRIBED AS FOLLOWS:

COMMENCING AT THE NORTHWEST CORNER OF SAID NORTHEAST QUARTER, THENCE ON AN ASSUMED BEARING OF SOUTH 00 DEGREES 12 MINUTES 46 SECONDS WEST ALONG THE WEST LINE OF SAID NORTHEAST QUARTER, A DISTANCE OF 2630.20 FEET TO THE NORTHWEST CORNER OF THE SOUTHEAST QUARTER OF SAID SECTION 23, THENCE SOUTH 00 DEGREES 12 MINUTES 29 SECONDS WEST ALONG THE WEST LINE OF SAID SOUTHEAST QUARTER, A DISTANCE OF 944.79 FEET TO A POINT OF INTERSECTION WITH THE NORTH RIGHT-OF-WAY LINE OF NEBRASKA HIGHWAY NUMBER 2, THENCE SOUTH 52 DEGREES 57 MINUTES 07 SECONDS EAST ALONG THE NORTH LINE OF SAID RIGHT-OF-WAY, SAID LINE BEING THE SOUTH LINE OF LOT 95 I.T., AND THE SOUTH RIGHT-OF-WAY LINE OF SOUTH 91ST STREET, A DISTANCE OF 212.50 FEET TO A SOUTHEAST CORNER OF LOT 95 I.T., SAID POINT BEING A SOUTHWEST CORNER OF SOUTH 91ST STREET RIGHT-OF-WAY AND THE **TRUE POINT OF BEGINNING**, THENCE NORTH 09 DEGREES 25 MINUTES 26 SECONDS EAST ALONG THE WEST LINE OF SAID SOUTH 91ST STREET RIGHT-OF-WAY, SAID LINE BEING THE EAST LINE OF SAID LOT 95 I.T., A DISTANCE OF 4.32 FEET TO A POINT, THENCE NORTH 85 DEGREES 41 MINUTES 38 SECONDS EAST, A DISTANCE OF 31.74 FEET TO A POINT, THENCE NORTH 44 DEGREES 20 MINUTES 22 SECONDS EAST, A DISTANCE OF 167.65 FEET TO A POINT OF INTERSECTION WITH THE EAST LINE OF SAID SOUTH 91ST STREET RIGHT-OF-WAY, SAID LINE BEING THE WEST LINE OF LOT 94 I.T., THENCE SOUTH 01 DEGREES 07 MINUTES 21 SECONDS WEST ALONG THE EAST LINE OF SAID RIGHT-OF-WAY, SAID LINE BEING THE WEST LINE OF SAID LOT 94 I.T., A DISTANCE OF 189.85 FEET TO A POINT, THENCE SOUTH 44 DEGREES 20 MINUTES 22 SECONDS WEST, A DISTANCE OF 12.66 FEET TO A POINT, THENCE SOUTH 04 DEGREES 18 MINUTES 22 SECONDS EAST, A DISTANCE OF 33.04 FEET TO A POINT OF INTERSECTION WITH THE NORTH RIGHT-OF-WAY LINE OF NEBRASKA HIGHWAY NUMBER 2, THENCE NORTH 52 DEGREES 57 MINUTES 07 SECONDS WEST ALONG THE NORTH LINE OF SAID RIGHT-OF-WAY, A DISTANCE OF 174.71 FEET TO THE POINT OF BEGINNING, SAID TRACT CONTAINS A CALCULATED AREA OF 15,578.78 SQUARE FEET OR 0.36 ACRES, MORE OR LESS.

October 25, 2001 (1:04PM)
F:\Projects\990677\lyplat\dwg\p4.rtf

**LEGAL DESCRIPTION
SO. 91ST STREET ROW
PARCEL 5**

A LEGAL DESCRIPTION FOR A TRACT OF LAND COMPOSED OF A PORTION OF LOT 95 I.T., LOCATED IN THE SOUTHEAST QUARTER OF SECTION 23, TOWNSHIP 9 NORTH, RANGE 7 EAST OF THE 6TH P.M., LANCASTER COUNTY, NEBRASKA, AND MORE PARTICULARLY DESCRIBED AS FOLLOWS:

COMMENCING AT THE NORTHWEST CORNER OF THE NORTHEAST QUARTER OF SAID SECTION 23, THENCE ON AN ASSUMED BEARING OF SOUTH 00 DEGREES 12 MINUTES 46 SECONDS WEST ALONG THE WEST LINE OF SAID NORTHEAST QUARTER, A DISTANCE OF 2630.20 FEET TO THE NORTHWEST CORNER OF SAID SOUTHEAST QUARTER, THENCE SOUTH 00 DEGREES 12 MINUTES 29 SECONDS WEST ALONG THE WEST LINE OF SAID SOUTHEAST QUARTER, A DISTANCE OF 944.79 FEET TO A POINT OF INTERSECTION WITH THE NORTH RIGHT-OF-WAY LINE OF NEBRASKA HIGHWAY NUMBER 2, THENCE SOUTH 52 DEGREES 57 MINUTES 07 SECONDS EAST ALONG THE NORTH LINE OF SAID RIGHT-OF-WAY, SAID LINE BEING THE SOUTH LINE OF SOUTH 91ST STREET RIGHT-OF-WAY AND THE SOUTH LINE OF SAID LOT 95 I.T., A DISTANCE OF 206.15 FEET TO A POINT, SAID POINT BEING **THE TRUE POINT OF BEGINNING**, THENCE NORTH 85 DEGREES 41 MINUTES 38 SECONDS EAST, A DISTANCE OF 5.79 FEET TO A POINT OF INTERSECTION WITH THE EAST LINE OF SAID LOT 95 I.T., SAID LINE BEING A WEST LINE OF SOUTH 91ST STREET RIGHT-OF-WAY, THENCE SOUTH 09 DEGREES 25 MINUTES 26 SECONDS WEST ALONG THE EAST LINE OF SAID LOT 95 I.T., SAID LINE BEING A WEST OF SAID RIGHT-OF-WAY, A DISTANCE OF 4.32 FEET TO THE SOUTHEAST CORNER OF SAID LOT 95 I.T., THENCE NORTH 52 DEGREES 57 MINUTES 07 SECONDS WEST ALONG THE SOUTH LINE OF SAID LOT 95 I.T., SAID LINE BEING THE NORTH RIGHT-OF-WAY LINE OF NEBRASKA HIGHWAY NUMBER 2, A DISTANCE OF 6.35 FEET TO THE POINT OF BEGINNING, SAID TRACT CONTAINS A CALCULATED AREA OF 12.16 SQUARE FEET, MORE OR LESS.

October 25, 2001 (1:59PM)
F:\Projects\990677\yplat\dwg\IP5.rtf

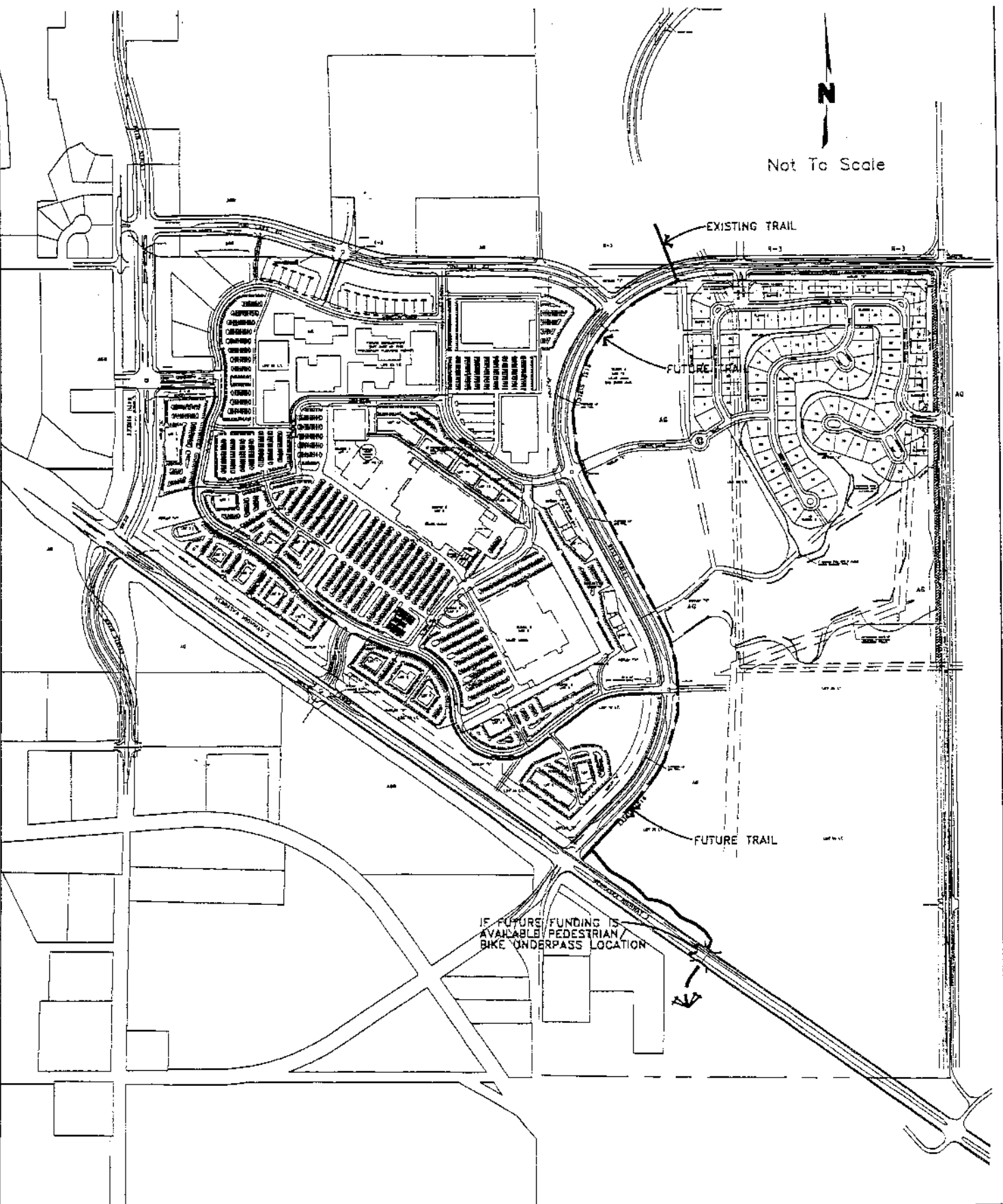

84TH & HIGHWAY 2
PROPOSED TRAIL

OLSSON ASSOCIATES

NG ENGINEERS

8/24/01

Attachment "0"

Box 84608, Lincoln, NE 68501

**MEMORANDUM OF THE CONDITIONAL ANNEXATION
AND ZONING AGREEMENT FOR S. 84TH & HIGHWAY 2**

This Memorandum of the Conditional Annexation and Zoning Agreement for S. 84th & Highway 2 ("Memorandum") is made and entered into as of this 13 day of Nov, 2001, by and between the **CITY OF LINCOLN, NEBRASKA**, a municipal corporation ("City"), **ANDERMATT, L.L.C.**, a Nebraska limited liability company ("Andermatt"), **EIGER CORP.**, a Nebraska corporation ("Eiger"), **WESTCOR, LLC**, a Nebraska limited liability company, formerly known as Westcore LLC ("Westcor"), **REALTY TRUST GROUP**, a Delaware corporation ("Realty Trust"), and **DAVID S. OLSON**, a married person ("Olson"), and is made with reference to the following:

A. **Memorandum.** This Memorandum is to indicate that the City, Andermatt, Eiger, Westcor, Realty Trust and Olson entered into the Conditional Annexation and Zoning Agreement for S. 84th & Highway 2, dated as of November 13, 2001 ("Annexation Agreement"). Andermatt, Eiger, Westcor, Realty Trust and Olson are sometimes referred to collectively as the "Property Owners". The Annexation Agreement is applicable to the tracts of real property legally described and shown on Exhibit "A", which is attached hereto and incorporated herein by this reference (collectively the "Property").

B. **Annexation Agreement.** The Annexation Agreement, among other things, outlines the following:

1. The City's approval of (a) annexation of a portion of the Property as the "First Phase Annexed Property", and (b) rezoning of portions of the Property as the "First Phase Rezoning".

2. The City's and Property Owners' obligations regarding the construction of the municipal improvements necessary for the annexation of all of the Property, including streets, water mains, sewers, and trails.

C. **Notice.** Any notices required to be forwarded to a party hereto shall be in writing and shall be served by mail, sufficient postage prepaid at the following addresses:

City	City of Lincoln Public Works Director 555 South 10 th Lincoln, NE 68508
with a copy to:	City Clerk 555 South 10 th Lincoln, NE 68508
Andermatt/Eiger:	Seacrest & Kalkowski, P.C. ATTN: Kent Seacrest 1111 Lincoln Mall, Suite 350 Lincoln, Nebraska 68508

STATE OF NEBRASKA)
) ss
COUNTY OF LANCASTER)

The foregoing was acknowledged before me this 28 day of August, 2001, by Kelvin Korver, Managing Member of **Andermatt, L.L.C.**, a Nebraska limited liability company, on behalf of the limited liability company.

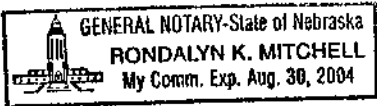

Rondalyn K. Mitchell
Notary Public

STATE OF NEBRASKA)
) ss
COUNTY OF LANCASTER)

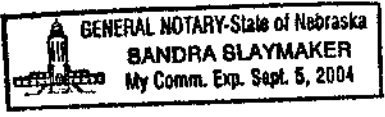

The foregoing was acknowledged before me this 27th day of August, 2000, by Greg Sutton, Managing Member of **Andermatt, L.L.C.**, a Nebraska limited liability company, on behalf of the limited liability company.

Sandra Slaymaker
Notary Public

“Eiger”

EIGER CORP., a Nebraska corporation

By: Greg Sutton
Greg Sutton, President

STATE OF NEBRASKA)
) ss
COUNTY OF LANCASTER)

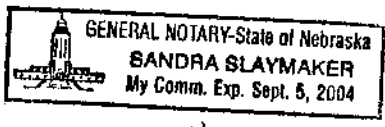

The foregoing was acknowledged before me this 27th day of August, 2001, by Greg Sutton, President of **Eiger Corp.**, a Nebraska corporation, on behalf of the corporation.

Sandra Slaymaker
Notary Public

"Westcor"

WESTCOR, LLC, a Nebraska limited liability company

By: *James M. Allen*
James M. Allen, Manager

By: *Judy A. Krasomil*
Judy A. Krasomil, Manager

STATE OF NEBRASKA)
) ss.
COUNTY OF LANCASTER)

The foregoing was acknowledged before me this 27 day of August, 2001, by James M. Allen, Manager of **Westcor, LLC**, a Nebraska limited liability company, on behalf of the limited liability company.

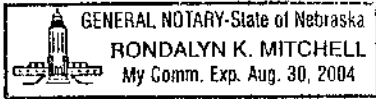

Rondalyn K. Mitchell
Notary Public

STATE OF NEBRASKA)
) ss.
COUNTY OF LANCASTER)

The foregoing was acknowledged before me this 27 day of August, 2001, by Judy A. Krasomil, Manager of **Westcor, LLC**, a Nebraska limited liability company, on behalf of the limited liability company.

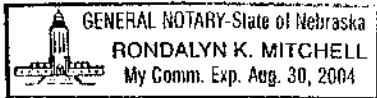

Rondalyn K. Mitchell
Notary Public

"Olson"



David S. Olson, a married person

STATE OF NEBRASKA)
) ss.
COUNTY OF LANCASTER)

The foregoing was acknowledged before me this 28th day of August, 2001, by **David S. Olson**, a married person.

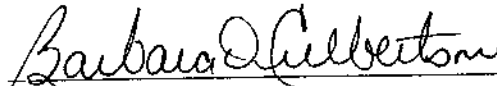
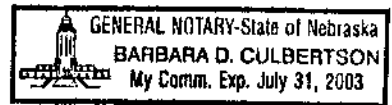
Notary Public

ATTACHMENT "A"

- Andermatt Tract: Lots 56, 66, 70, 71, 72, 78, 79, 80, 81, 91, 92, and a portion of Lot 82, Irregular Tracts, all located in Section 23, and Lots 6 and 38, Irregular Tracts located in Section 14, all located in Township 9 North, Range 7 East of the 6th P.M., Lancaster County Nebraska.
- Eiger Tract: Lot 90 and a portion of Lot 82, Irregular Tract located in Section 23, Township 9 North, Range 7 East of the 6th P.M., Lancaster County, Nebraska.
- Olson/Realty Trust Tract: Lot 58, Irregular Tract located in Section 23, Township 9 North, Range 7 East of the 6th P.M., Lancaster County, Nebraska.
- Westcor Tract: Lots 87 and 84, Irregular Tract located in Section 23, Township 9 North, Range 7 East of the 6th P.M., Lancaster County Nebraska.
- Johnson Tract Lot 36, Irregular Tract located in Section 23, Township 9 North, Range 7 East of the 6th P.M., Lancaster County, Nebraska.
- City Tract: Lot 85, Irregular Tract located in Section 23, Township 9 North, Range 7 East of the 6th P.M., Lancaster County Nebraska.